

**Floating Wall** system is designed to can be a very easy way to adjust shelves and components as life changes.

Panels hang on the wall with two cleats and can be relocated to new location by just lifting panel and reinstalling cleats.

Shelving and components clip on to panel. Each section locks in place with set screws. Each component can be easily moved from one location to new location.

Maple, walnut, cherry, white oak, and red oak are our stock veneers, others can be custom ordered.

Most woods are in a stock list, other veneers are available. Custom veneers are selected and laid-up in house.

Each unit is designed and built to order. Veneer is book matched and sequenced to be the same color and grain.

## Shelves and component specifications

Shelves are 12" deep. Base component's are 12", 16" and 22" inches deep.

Panels and components come in three sizes 24", 32" and 42".

Wall panels can be ordered to the exact height up to 96". For higher panels, a seam can be made at the desk height or longer veneer can be laid-up to fit the exact height. There is a required 1" deduction from the ceiling to hang onto the cleats.

Panels can be mounted above existing baseboard or molding.

All of the pieces in this line are finished in a nontoxic hand applied oil. This finish does wonders to enhance the natural beauty of the wood and will last a life time with simple maintenance by the owner.

**“Making it work as easily as possible”**

# Floating wall specifications:

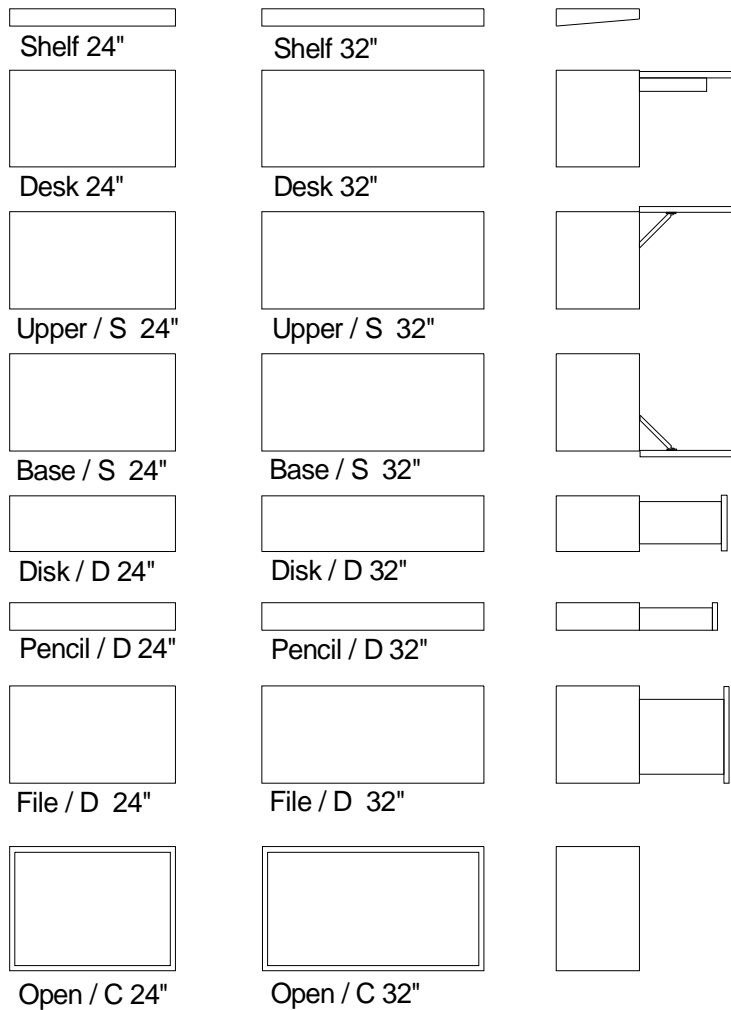

Wood species

Maple \* Walnut \* Cherry \* White oak \* Red oak \*

Other veneers and finishes are available upon request.

Sliding / C 42" can be ordered with solid panels, Gray lite glass for stereo components, or our "Sea Glass Craft" panels.

File / D is designed to hold hanging folders to width of cabinet for the 16" and 22" deep componets. 12" File / D file are on runners from front to back.

